

NOTTINGHAM STREET
 PROPOSED RETAINING WALL PLAN
 SCALE 1:200

LEGEND:

- 8.5 EXISTING CONTOUR LEVELS
- TOW 9.53 PROPOSED LEVELS
- C—J PROPOSED CONTROL JOINT LOCATION - REFER TO S006-03 FOR DETAILS
- ① WALL NUMBER - REFER TO S006-02 FOR DETAILS

- NOTES:**
1. PLANS TO READ IN CONJUNCTION WITH ALL OTHER ISSUED DRAWINGS.
 2. SEE S006-03 FOR STANDARD DETAILS
 3. ALL DIMENSIONS AND SET-OUT TO BE CONFIRMED ON SITE WITH HOME OWNER PRIOR TO CONSTRUCTION.

TOWN OF VICTORIA PARK
 Received: 4 March 2026

PAUL DRAPER
 MIEAUST 1186530
 SIGNED.....

D	AMENDED DUE TO COUNCIL COMMENTS. REISSUED FOR CDC & COUNCIL APPROVAL	27/2/26	ML	PD
C	AMENDED DUE TO COUNCIL COMMENTS. REISSUED FOR CDC & COUNCIL APPROVAL	11/12/25	ML	PD
B	ISSUED FOR CDC & COUNCIL APPROVAL	24/09/25	ML	PD
A	ISSUED FOR CLIENT APPROVAL	15/09/25	ML	PD
REV	AMENDMENT	DATE	DRN	CHKD
CLIENT:		CONTRACTOR:		
P. FOSTER				
PROJECT: 5 NOTTINGHAM STREET, EAST VIC PARK				
TITLE: SITE & RETAINING WALL PLAN				
CONSTRUCTION				
DATE:	SCALE:	DRN:		
02/09/25	AS SHOWN @ A1	MARK LIPARI		
DWG NO:	REV:			
S006-01	D			

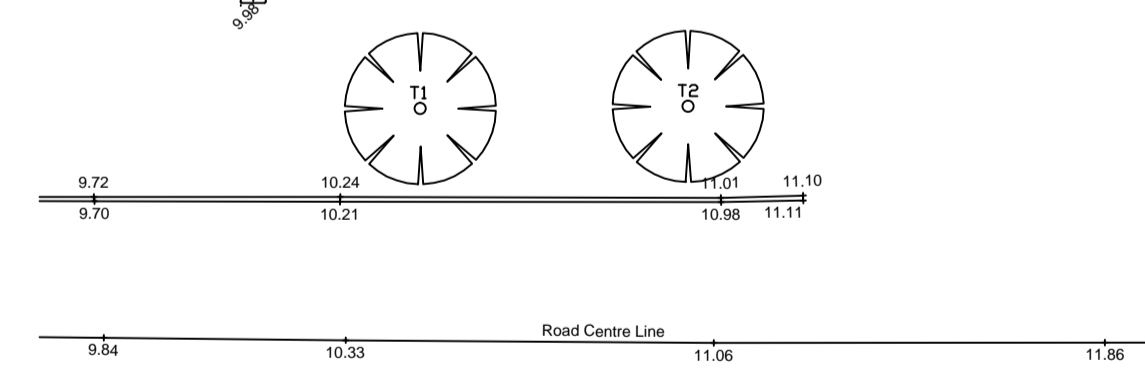
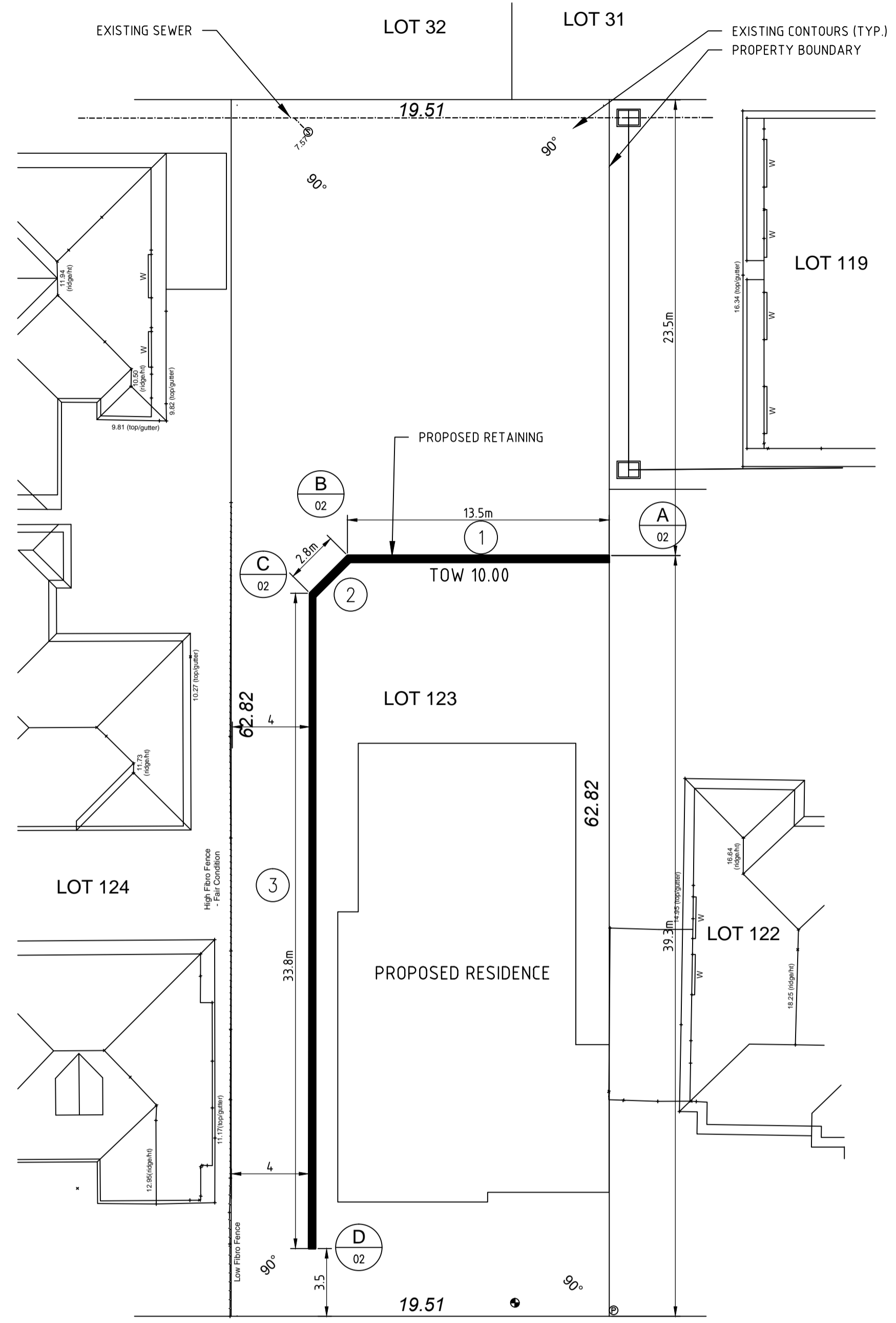
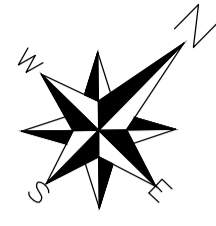

NOTTINGHAM STREET
 PROPOSED RETAINING WALL PLAN
 SCALE 1:200

TOWN OF VICTORIA PARK
 Received: 4 March 2026

REV	AMENDMENT	DATE	DRN	CHKD
CLIENT:	P. FOSTER		CONTRACTOR:	
			STONECIVIL	
PROJECT:	5 NOTTINGHAM STREET, EAST VIC PARK			
TITLE:	SITE & RETAINING WALL PLAN INFORMATION			
DATE:	04/03/26	SCALE:	AS SHOWN @ A1	DRN:
				MARK LIPARI
DWG NO:	SKETCH - PLAN			REV:
				B

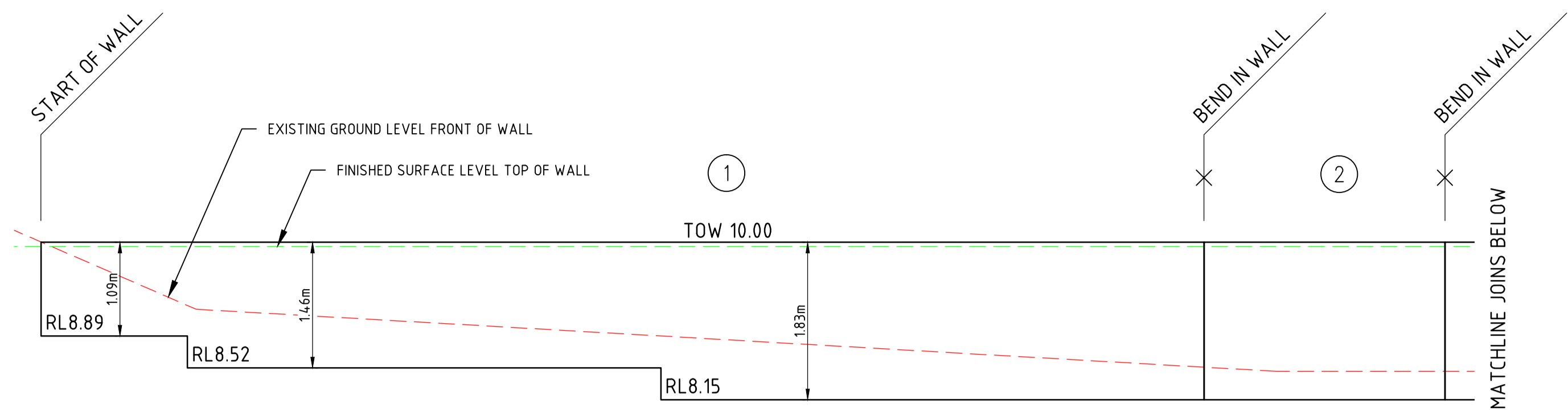

ELEVATION 1 & 2
SCALE 1:50

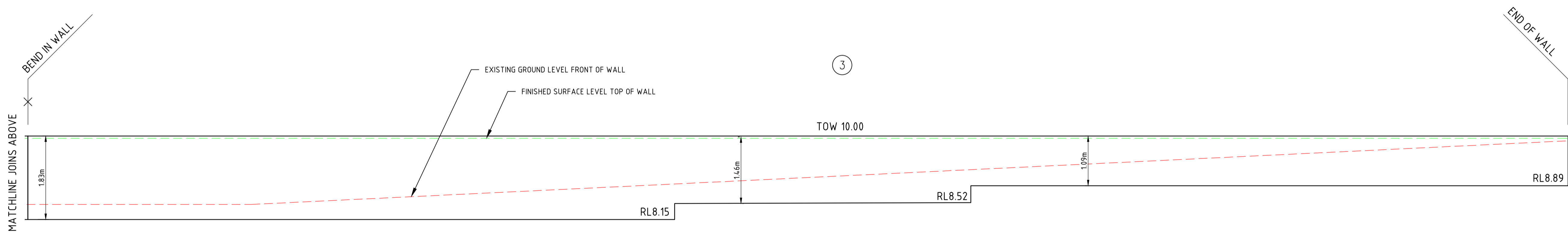

ELEVATION 3
SCALE 1:50

TOWN OF VICTORIA PARK
Received: 4 March 2026

REV	AMENDMENT	DATE	DRN	CHKD
CLIENT: P. FOSTER		CONTRACTOR:		
PROJECT: 5 NOTTINGHAM ST, EAST VIC PARK				
TITLE: RETAINING WALL PROFILES INFORMATION				
DATE: 04/03/26	SCALE: AS SHOWN @ A1	DRN: MARK LIPARI		
DWG NO: SKETCH 2				REV: B

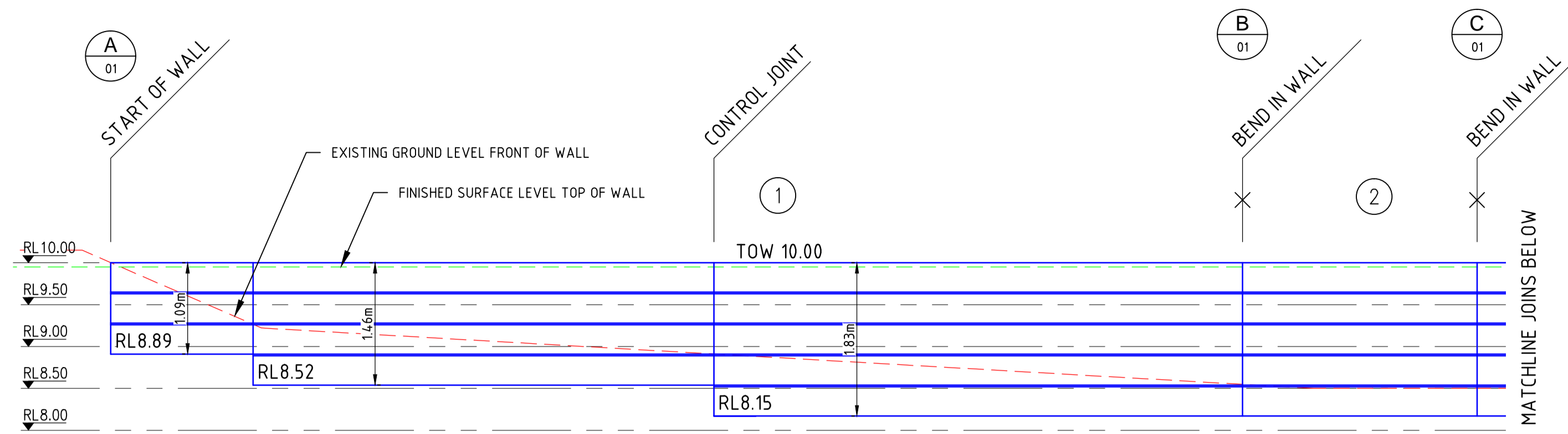

COURSES	3	4	5	5
LENGTH & DIRECTION	1.7m NE	5.5m NE	6.3m NE	2.8m W
TOW LEVEL	10.00	10.00	10.00	10.00
BOTTOM GL	10.00	9.27	8.91	8.50
CHAINAGE	0.00	1.70	7.20	13.50

RETAINING WALL LONGSECTION
SCALE 1:50

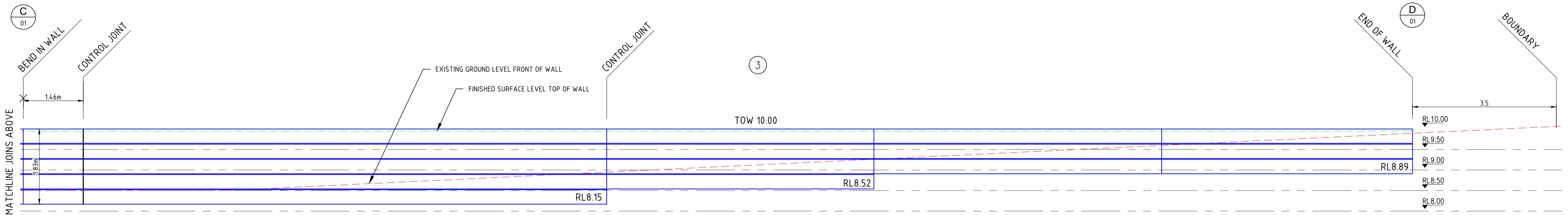

COURSES	5	4	3 (2exp)	3 (1exp)
LENGTH & DIRECTION	14.2m SW	6.5m SW	7m SW	6.1m SW
TOW LEVEL	10.00	10.00	10.00	10.00
BOTTOM GL	8.50	8.95	9.27	9.69
CHAINAGE	16.3	30.50	37.00	44.00

RETAINING WALL LONGSECTION - CONT
SCALE 1:50

TOWN OF VICTORIA PARK
Received: 4 March 2026

PAUL DRAPER
MIEAUST 1186530
SIGNED.....

D	AMENDED DUE TO COUNCIL COMMENTS. REISSUED FOR CDC & COUNCIL APPROVAL	27/2/26	ML	PD
C	AMENDED DUE TO COUNCIL COMMENTS. REISSUED FOR CDC & COUNCIL APPROVAL	11/12/25	ML	PD
B	ISSUED FOR CDC & COUNCIL APPROVAL	24/09/25	ML	PD
RAV	ISSUED FOR CLIENT APPROVAL	15/08/25	DRN	CHP
CLIENT:	P. FOSTER		CONTRACTOR:	
	5 NOTTINGHAM ST, EAST VIC PARK		STONECIVIL	
PROJECT:	5 NOTTINGHAM ST, EAST VIC PARK			
TITLE:	RETAINING WALL PROFILES CONSTRUCTION			
DATE:	02/09/2025	SCALE:	AS SHOWN @ A1	DRN:
				MARK LIPARI
DWG NO:	S006-02			REV:
				D

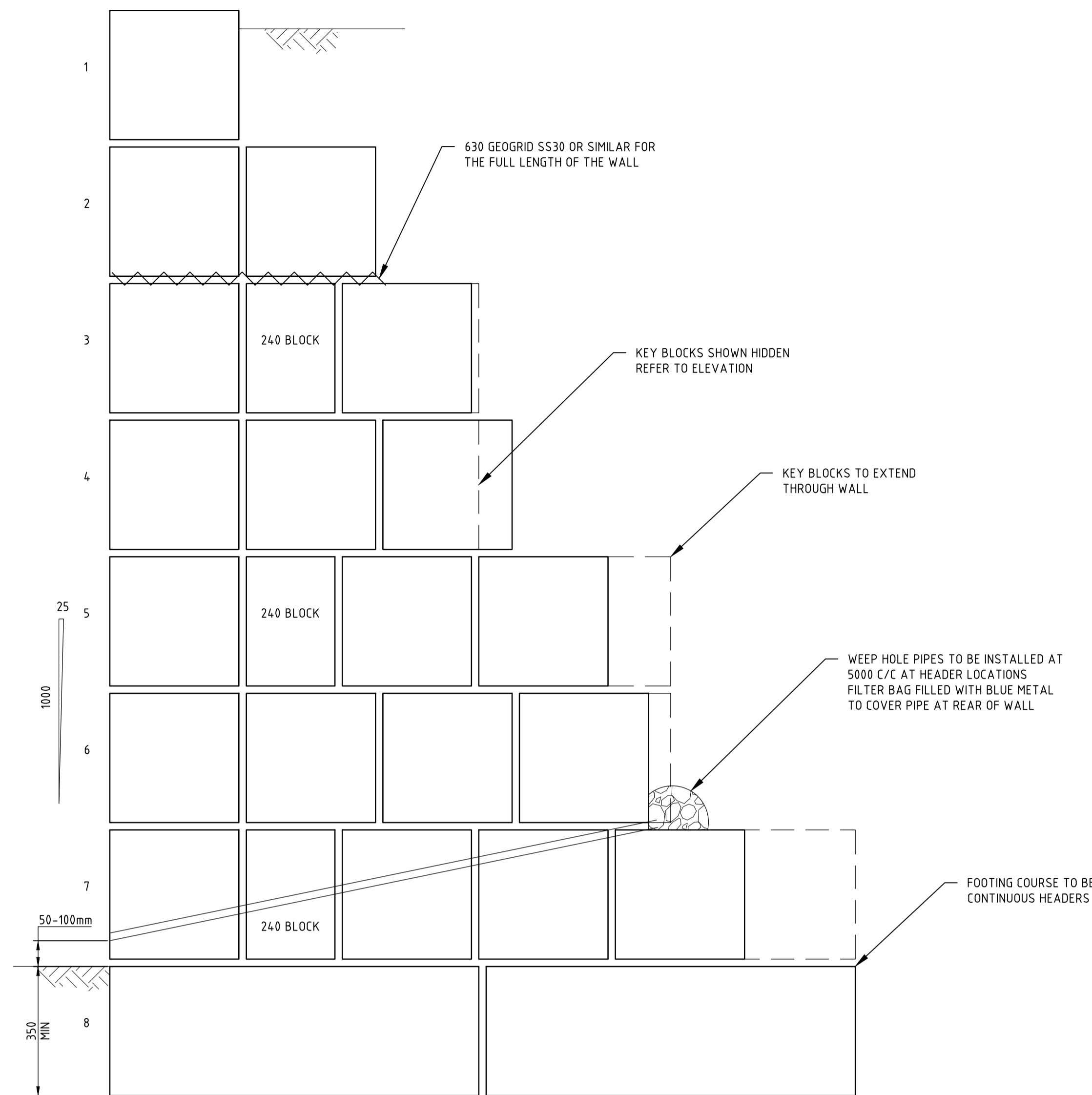

STANDARD WALL DETAIL
SCALE 1:10

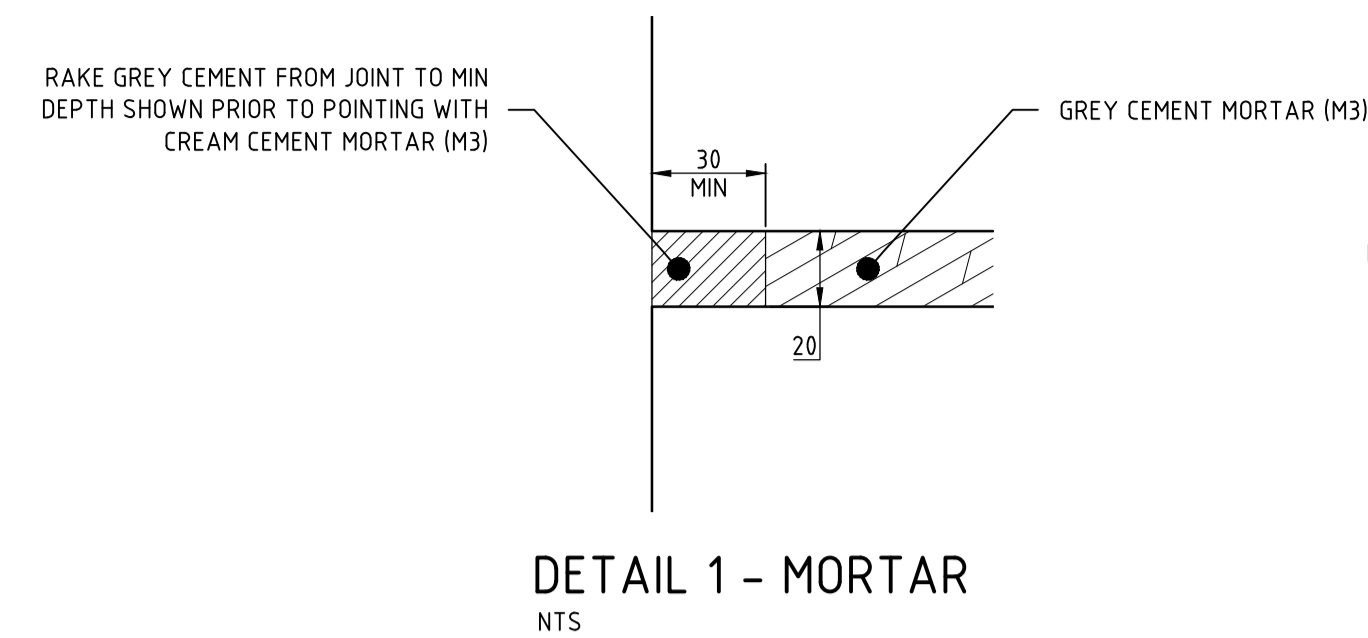

DETAIL 1 - MORTAR
NTS

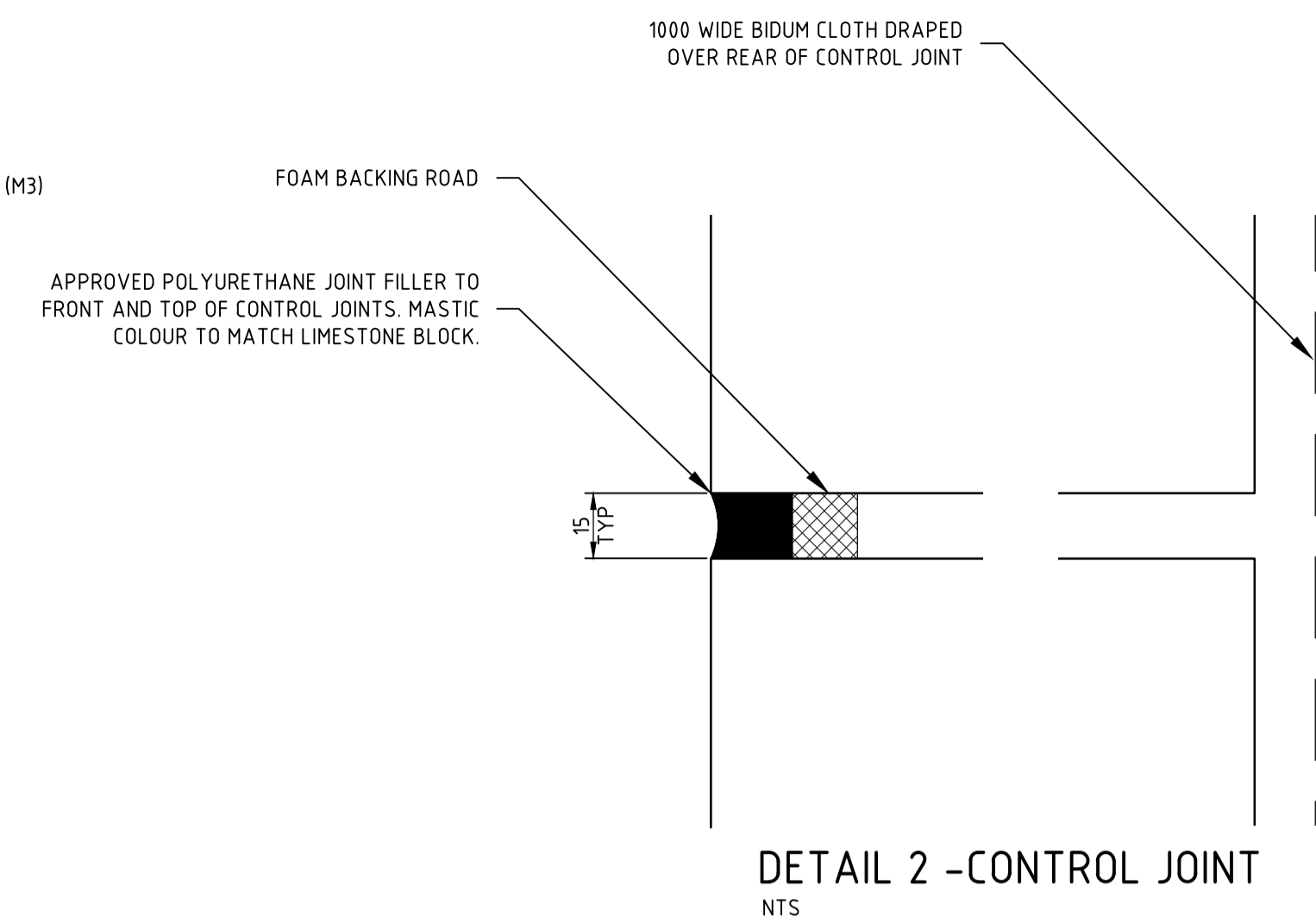

DETAIL 2 - CONTROL JOINT
NTS

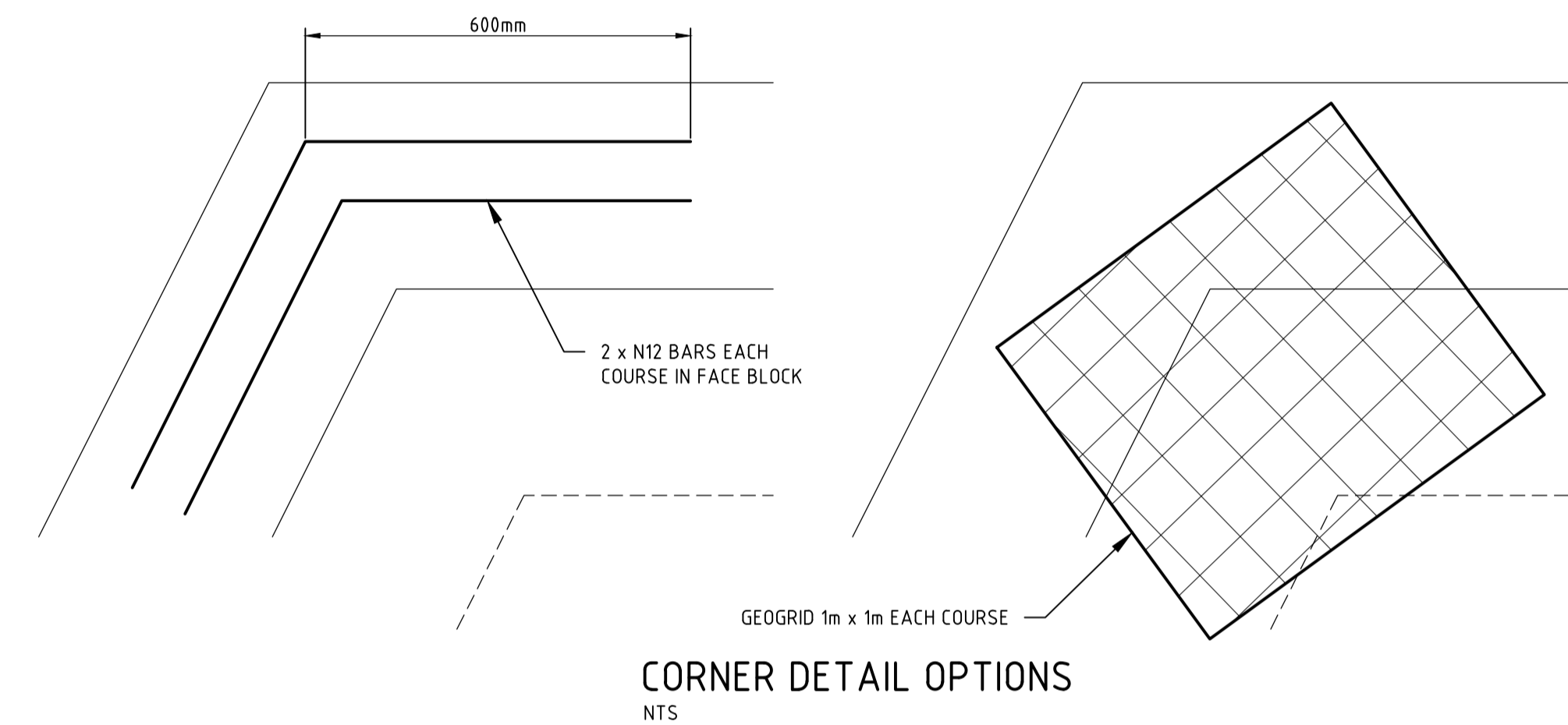

CORNER DETAIL OPTIONS
NTS

TOWN OF VICTORIA PARK
Received: 4 March 2026

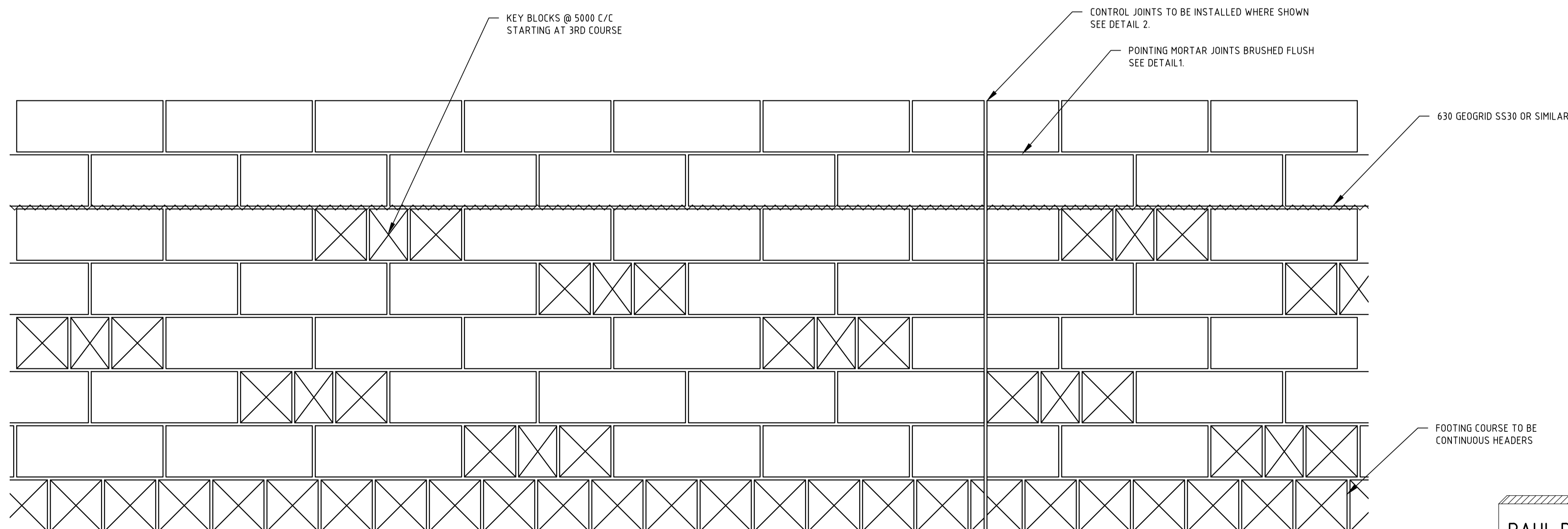

TYPICAL RETAINING WALL ELEVATION
SCALE 1:20

PAUL DRAPER
MIEAUST 1186530
SIGNED.....

GENERAL NOTES:

1. ALL EARTHWORKS TO BE COMPACTED TO 95% MDD OR 8 BLOWS ON A STANDARD PERTH SAND PENETROMETER.
2. ALL BLOCKS TO BE RECONSTITUTED LIMESTONE WITH A COMPRESSIVE STRENGTH OF 5MPa AND DENSITY OF 1750KG/M3
3. MORTAR MIX TO BE 1:1:6 (M3)
4. CONTROL JOINTS AT LOCATIONS SHOWN ON PLAN
5. DIMENSIONS ARE IN mm UNLESS NOTED OTHERWISE

D	AMENDED DUE TO COUNCIL COMMENTS. REISSUED FOR CDC & COUNCIL APPROVAL	27/2/26	ML	PD	
C	AMENDED DUE TO COUNCIL COMMENTS. REISSUED FOR CDC & COUNCIL APPROVAL	11/12/25	ML	PD	
B	ISSUED FOR CDC & COUNCIL APPROVAL	24/09/25	ML	PD	
A	ISSUED FOR CLIENT APPROVAL	15/09/25	ML	PD	
REV		DATE	DRN	CHKD	
CLIENT:	AMENDMENT		CONTRACTOR:		
P. FOSTER					
PROJECT: 5 NOTTINGHAM ST, EAST VIC PARK					
TITLE: RETAINING WALL DETAILS					
CONSTRUCTION					
DATE:	02/09/2025	SCALE:	AS SHOWN @ A1	DRN:	MARK LIPARI
DWG NO:	S006-03			REV:	D